

<input type="checkbox"/> Touchstone Imaging Lakewood I-70 & Denver West / Colorado Mills Exit 303-216-9000 • Fax: 303-216-2101 TAX ID # 47-2294770 • NPI # 1497152920	<input type="checkbox"/> Touchstone Imaging Dry Creek I-25 and the Dry Creek Road Exit 303-662-1674 • Fax: 303-662-1601 TAX ID # 47-2294770 • NPI # 1407253982	<input type="checkbox"/> Touchstone Imaging Highline Broadway & Dry Creek Rd., • 1 Mile North of C-470 720-889-2795 • Fax: 720-889-2812 TAX ID # 47-2294770 • NPI # 1568869055
<input type="checkbox"/> Touchstone Imaging Aurora Dartmouth & Parker Rd., • 3/4 Mile West of I-225 303-632-2222 • Fax: 303-632-2210 TAX ID # 47-2294770 • NPI # 1962882506	<input type="checkbox"/> Touchstone Imaging Thornton I-25 & the 120th Avenue Exit 303-991-2021 • Fax: 303-991-2026 TAX ID # 47-2294770 • NPI # 1649677170	<input type="checkbox"/> Touchstone Imaging Lafayette Empire Road just West of Highway 287 303-253-3280 • Fax: 303-253-3281 TAX ID # 47-2294770 • NPI # 1184021099
<input type="checkbox"/> Touchstone Imaging Uptown A 1/2 mile East of the Capitol at Colfax & Ogden 303-248-5355 • Fax: 303-248-5354 TAX ID # 47-2294770 • NPI # 1790182509	<input type="checkbox"/> Touchstone Imaging Wheat Ridge Just West of Wadsworth on 38th Ave. 303-318-2900 • Fax: 303-632-2720 TAX ID # 47-2294770 • NPI # 1700283496	<input type="checkbox"/> Touchstone Imaging Mammography and Bone Density On N Lutheran Pkwy, Between Kipling & Wadsworth 720-683-3005 • Fax: 303-632-2730 TAX ID # 47-2294770 • NPI # 1447611454

Patient Information:

Call patient to schedule May modify exam at radiologist's discretion if clinically indicated

Name: _____ DOB: _____

Home Phone #: _____ Alternate Phone #: _____

Please assist in authorization (fax order, patient demographics, insurance card, clinical notes and labs pertaining to exam to the appropriate facility).

Insurance Provider: _____

ID #: _____

Pre-Authorization obtained by referring physician's office

Ins. Authorization #: _____

Ordering Physician: _____ Signature: _____

Today's Date: _____ Phone #: _____ Fax #: _____

STAT Hold Patient & Call Results to #: _____ Cell #: _____ Back Line #: _____

STAT Release Patient & Call Results to #: _____ Cell #: _____ Back Line #: _____

CD & Report via courier Films & Report via courier Films w/ patient CD w/ patient Report Only

MRI / MRA: _____ **Diagnosis:** _____

Arthrogram w/MRI _____

CT / CTA: _____

Ultrasound: _____ **History & Symptoms:** _____

X-Ray: _____

Fluoroscopy: _____

UGI* **SBFT*** **Esophogram/Barium Swallow*** May modify exam at radiologist's discretion if clinically indicated

*These services only available at Dry Creek, Lafayette, Lakewood, Thornton and Uptown.

Mammography: Available at Mammography and Bone Density only. **Special Instructions:** _____

2D Screening 3D Screening

Bone Density Postmenopausal Osteopenia Osteoporosis Other _____

Cardiac Calcification Scoring

- Touchstone Imaging Dry Creek Touchstone Imaging Highline Touchstone Imaging Thornton

Touchstone Imaging
HIGHLINE

**Broadway & Dry Creek Rd.,
1 Mile North of C-470**

Touchstone Imaging Highline is located in the Kellogg Building at 26 West Dry Creek Circle. At the intersection of South Broadway and West Dry Creek Circle / Dry Creek Rd. (one block north of Littleton Hospital) turn west on Dry Creek Circle. Turn left at 26 West Dry Creek Circle at the Kellogg Building. This is a six-story red brick building. Follow the signs posted in the parking lot to guide you to Touchstone Imaging Highline, located in the back of the building. Park in the reserved parking spaces. Enter through the side door to Suite 160 on the ground floor.

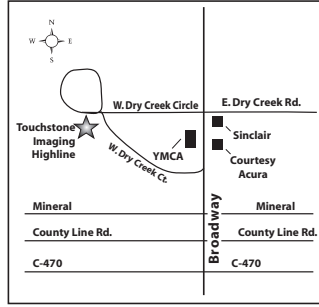

**26 West Dry Creek Circle, Suite 160
Littleton, Colorado 80120
Phone: 720-889-2795
Fax: 720-889-2812**

Touchstone Imaging
LAKEWOOD

I-70 and the Denver West / Colorado Mills Exit
If heading West on I-70: Exit at Denver West Blvd. #263 and turn right (north). Go 1/2 block to Denver West Parkway and turn right (east), turn at second lot entrance on right (Bldg. #52)

If heading East on I-70: Exit at Denver West Blvd. #263 and turn left (north). Pass over bridge to Denver West Parkway and turn right (east), turn at second lot entrance on right (Bldg. #52)

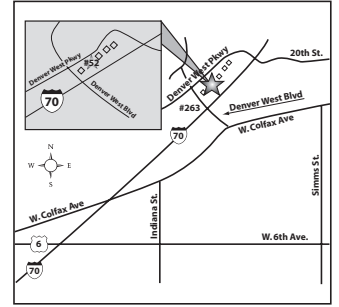

**14062 Denver West Parkway
Building 52, Suite 180
Lakewood, Colorado 80401
Phone: 303-216-9000
Fax: 303-216-2101**

Touchstone Imaging
DRY CREEK

I-25 and the Dry Creek Road Exit

From I-25 take the Dry Creek Exit which is just south of the DTC area. Go east three traffic lights. At the fourth traffic light, turn right at Inverness Drive east (go past Inverness Drive west). We are located in the three-story medical office building named "Dry Creek Medical Campus". Turn immediately left into the parking lot. The entrance faces the parking lot. Check-in at Suite 140.

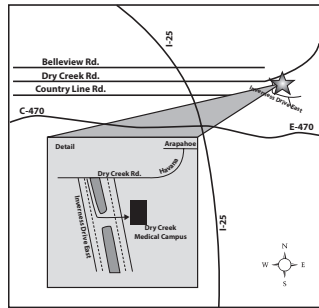

**125 Inverness Drive East, Suite 140
Englewood, Colorado 80112
Phone: 303-662-1674
Fax: 303-662-1601**

Touchstone Imaging
LAFAYETTE

Empire Road just West of Highway 287

From Hwy 287 go west on Empire Road. Then turn south onto Autumn Ridge Blvd and then left onto Whitetail Circle and take another left into our parking lot. Touchstone Imaging Lafayette is located in the south building in Suite 102.

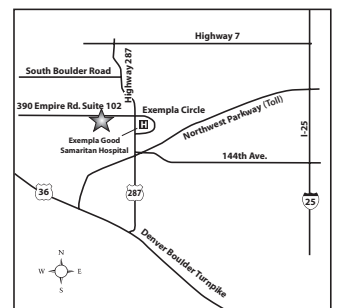

**390 Empire Rd., Suite 102
Lafayette, CO 80026
Phone: 303-253-3280
Fax: 303-253-3281**

Touchstone Imaging
THORNTON

I-25 and the 120th Avenue Exit

From I-25, go east on 120th. At the second traffic light, turn left on Pennsylvania St. After the "traffic island", you will turn left in the "Penn Plaza" parking lot. Proceed through the courtyard to Suite 106.

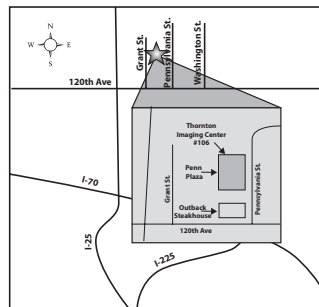

**12021 Pennsylvania St., Suite 106
Thornton, Colorado 80241
Phone: 303-991-2021
Fax: 303-991-2026**

Touchstone Imaging
UPTOWN

**A 1/2 mile East of the Capitol
at Colfax and Ogden**

Located at the northeast corner of Colfax and Ogden, just a half mile east of the State Capitol. We have ample free parking. Beware that Ogden is a south bound one way street. If driving east toward Touchstone Imaging Uptown along Colfax, you cannot turn left onto Ogden, however you can turn left into our parking lot just past Ogden. You'll see a "No Left Turn" sign, but that sign is intended for Ogden. If driving west along Colfax, Touchstone Imaging Uptown is 1.7 miles west of Colorado Blvd.

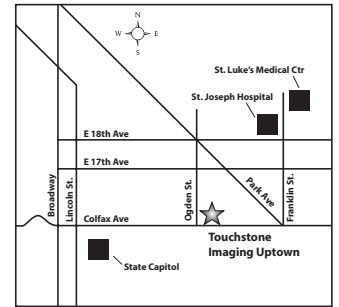

**1007 E Colfax Ave
Denver, CO 80218
Phone: 303-248-5355
Fax: 303-248-5354**

Touchstone Imaging
WHEAT RIDGE

**Just West of Wadsworth on
38th Ave.**

Touchstone Imaging Wheat Ridge is on the north side of 38th Avenue just west of Wadsworth. There is a Touchstone Imaging sign over the entrance on our building which directly faces 38th Avenue. Pull in the parking lot and take an immediate right and you can park directly in front of our suite, which is B115.

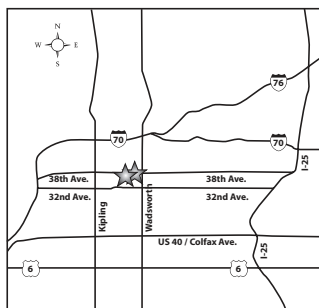

**7615 West 38th Avenue, Suite B115
Wheat Ridge, Colorado 80033
Phone: 303-318-2900
Fax: 303-632-2720**

Touchstone Imaging
MAMMOGRAPHY AND BONE DENSITY

**3455 N Lutheran Parkway, Suite 110
Wheat Ridge, Colorado 80033
Phone: 720-683-3005
Fax: 303-632-2730**

On N Lutheran Pkwy, Between Kipling & Wadsworth

N Lutheran Pkwy is west of Wadsworth on the south side of 38th Avenue. After turning onto N Lutheran Pkwy from 38th Ave., go past the main hospital to the 4th stop sign and turn right. Our building has a Children's Hospital Colorado logo on it. We are at entrance # 7 and you will find parking in front of the building.

Touchstone Imaging
AURORA

**Roughly 3/4 of a mile
West of I-225
at South Parker Road
& Dartmouth**

From I-225 head northwest on S Parker Road roughly 3/4 of a mile. Touchstone Imaging Aurora is just past Dartmouth on the left, however our parking lot can be accessed from both S Parker Road or from Dartmouth.

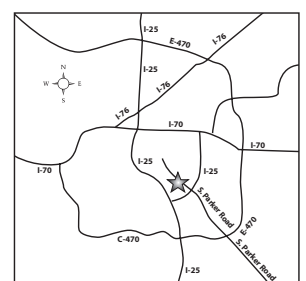

**3055 South Parker Rd.
Suite 103
Aurora, CO 80014
Phone: 303-632-2222
Fax: 303-632-2210**